

Gasoline and Electric
Vehicles:

- Carryall 2
- Carryall 6

Canopy Kit Installation Instructions

Publication
SVP190601

Edition Code
0702A00000

These instructions apply to the following kit:

SVP115801



GENERAL INFORMATION AND PRECAUTIONS

This instruction provides detailed instructions for the installation of a canopy on Carryall 2 and Carryall 6 vehicles. Ensure that all necessary replacement parts, the appropriate maintenance and service manual(s), and this document are available before this kit is installed. Thoroughly review this document before any installation procedures are performed. Statements labeled NOTE provide additional information that is essential for the proper installation of this kit.

The following safety statements relate to specific safety issues and must be read, understood, and heeded before a kit is installed. Failure to do so could result in personal injury and/or property damage.

DANGER

- **Battery – Explosive gases! Do not smoke. Keep sparks and flames away from the vehicle and service area. Ventilate when charging or operating vehicle in an enclosed space. Wear a full face shield and rubber gloves when working on or near batteries.**
- **Battery – Poison! Contains acid! Causes severe burns. Avoid contact with skin, eyes, or clothing. Antidotes:**
 - **External: Flush with water. Call a physician immediately.**
 - **Internal: Drink large quantities of milk or water. Follow with milk of magnesia or vegetable oil. Call a physician immediately.**
 - **Eyes: Flush with water for 15 minutes. Call a physician immediately.**
- **Gasoline – Flammable! Explosive! Do not smoke. Keep sparks and flames away from the vehicle and service area. Service only in a well-ventilated area.**
- **Do not operate gasoline vehicle in an enclosed area without proper ventilation. The engine produces carbon monoxide, which is an odorless, deadly poison.**

WARNING

- **Follow the procedures exactly as stated in this instruction, and heed all DANGER, WARNING, and CAUTION statements in this instruction as well as those on the vehicle and battery charger.**
- **Only trained technicians should service or repair the vehicle or battery charger. Anyone doing even simple repairs or service should have knowledge and experience in electrical and mechanical repair. The appropriate instructions must be used when performing maintenance, service, or accessory installation.**
- **Prior to servicing the vehicle or leaving the vehicle unattended, turn the key switch OFF, remove the key, and place the Forward/Reverse handle in the NEUTRAL position. Chock the wheels when servicing the vehicle.**
- **To avoid unintentionally starting the vehicle, disconnect the batteries as shown (Figure 1 and Figure 2).**
- **Frame ground – Do not allow tools or other metal objects to contact frame when disconnecting battery cables or other electrical wiring. Do not allow a positive wire to touch the vehicle frame, engine, or any other metal component.**
- **Wear safety glasses or approved eye protection when servicing the vehicle or battery charger. Wear a full face shield and rubber gloves when working on or near batteries.**
- **Do not wear loose clothing or jewelry such as rings, watches, chains, etc., when servicing the vehicle or battery charger.**
- **Moving parts! Do not attempt to service the vehicle while it is running.**

WARNING CONTINUED ON NEXT PAGE...

⚠ WARNING

- **Hot!** Do not attempt to service hot engine, exhaust system, or motor. Failure to heed this warning could result in severe burns.
- Use insulated tools when working near batteries or electrical connections. Use extreme caution to avoid shorting of components or wiring.
- Lift only one end of the vehicle at a time. Use a suitable lifting device (chain hoist or hydraulic floor jack) with 1000 lb. (454 kg) minimum lifting capacity. Do not use lifting device to hold vehicle in raised position. Use approved jack stands of proper weight capacity to support the vehicle and chock the wheels that remain on the floor. When not performing a test or service procedure that requires movement of the wheels, lock the brakes.
- If wires are removed or replaced, make sure wiring and wire harness are properly routed and secured. Failure to properly route and secure wiring could result in vehicle malfunction, property damage, personal injury, or death.
- For vehicles with cargo beds, remove all cargo before raising the bed or servicing the vehicle. If the vehicle is equipped with a prop rod, ensure that it is securely engaged while bed is raised. Do not close bed until all persons are clear of cargo bed area. Keep hands clear of all crush areas. Do not drop cargo bed; lower gently and keep entire body clear. Failure to heed this warning could result in severe personal injury or death.

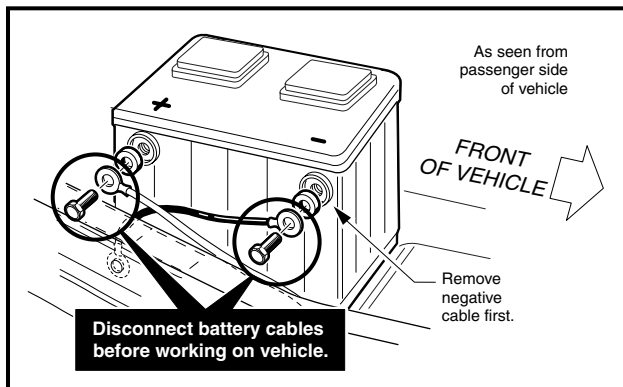

Figure 1 Battery Disconnect – Gasoline Vehicle

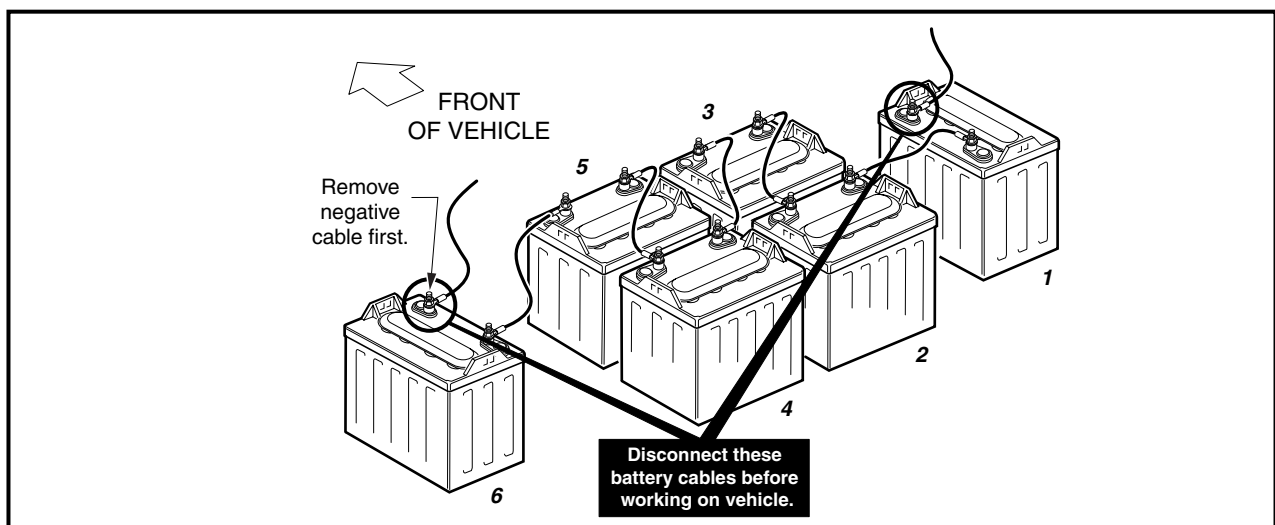
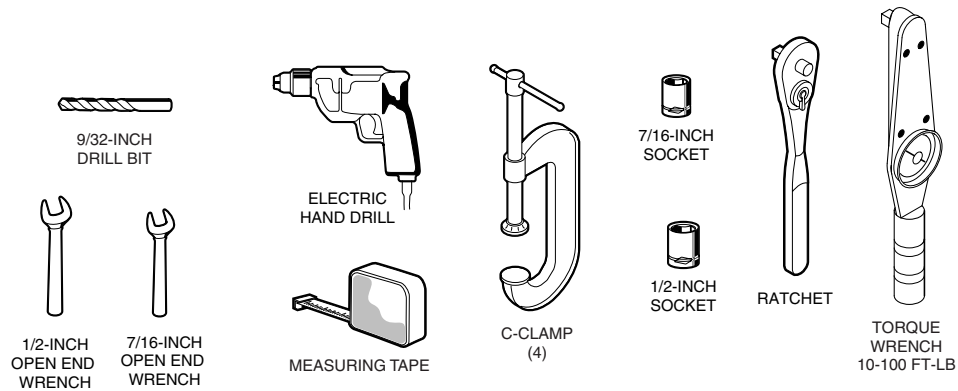
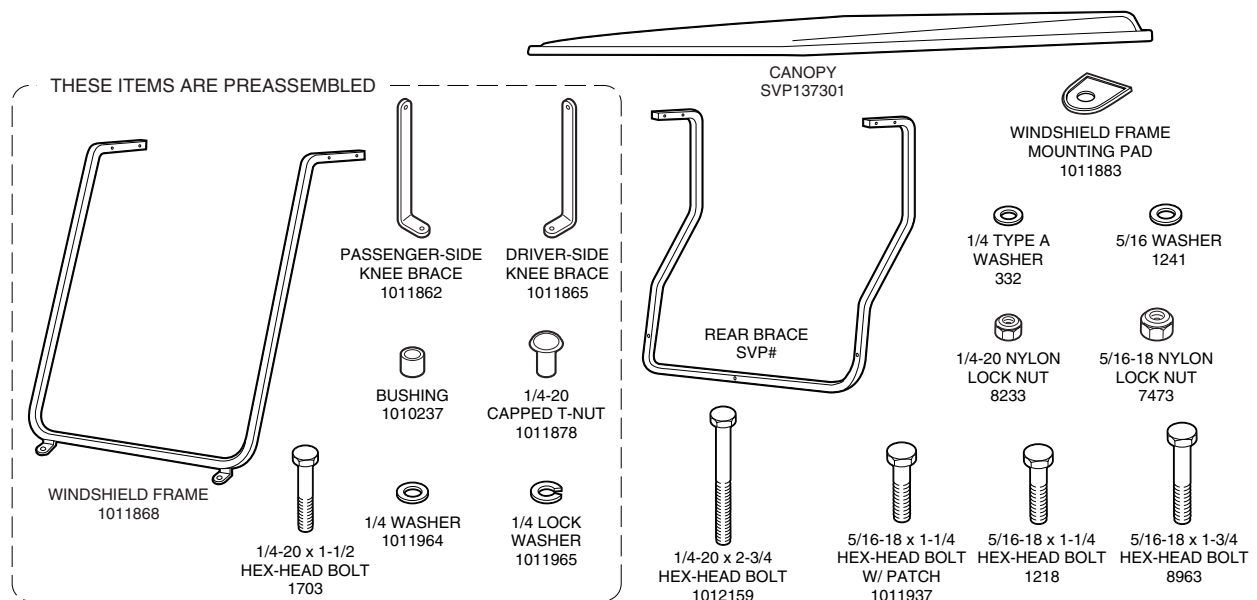

Figure 2 Battery Disconnect – Electric Vehicle

TOOLS REQUIRED



PARTS IN THIS KIT



1. DISABLE THE VEHICLE

- 1.1. Turn the key switch to the OFF position and remove the key, place the Forward/Reverse handle in the NEUTRAL position and chock the wheels.
- 1.2. Disconnect the battery cables as instructed. **See "To avoid unintentionally starting..." WARNING on page 2.**

2. INSTALL WINDSHIELD FRAME

- 2.1. Remove and discard the nuts (1), washers (2), and bolts (3) securing the trim (4) to the front body (7) of the vehicle (**Figure 3**).
- 2.2. Remove and discard the Phillips-head screw (6) from each side of the front body (7).

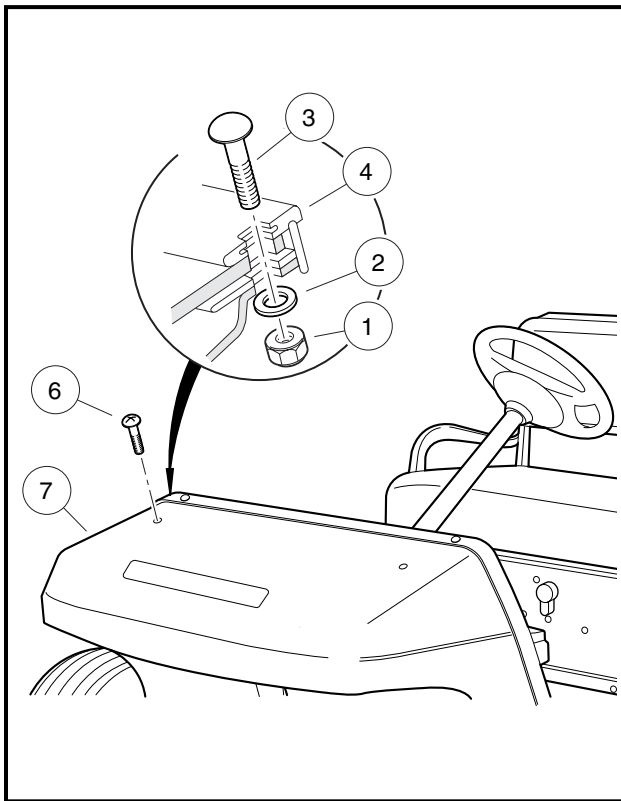

Figure 3 Remove Hardware from Front Body

- 2.3. Position the two windshield frame mounting pads (1) between the bracket and front body as shown (**Figure 4**).
- 2.4. Secure the windshield frame (2) to the front body with two 5/16-18 x 1-1/4 hex-head bolts with patch (3).
- 2.5. Secure the knee braces (6 and 7) to the front body with two 5/16-18 x 1-1/4 hex-head bolts (8), washers (9), and lock nuts (10). Tighten the hardware to 45 in-lb (5.1 N·m).

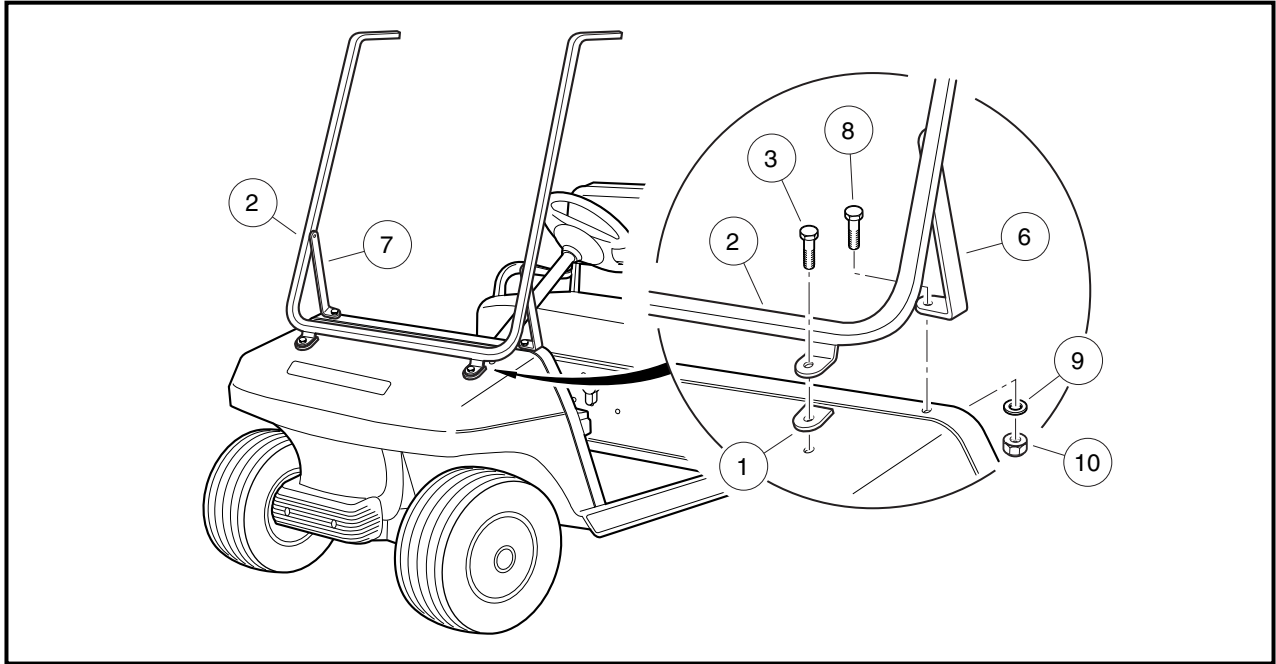

Figure 4 Secure Windshield Frame to Front Body

3. INSTALL REAR BRACE

- 3.1. Locate the three rear brace mounting holes (one each side, one center) in the seat back support (Figure 5).
- 3.2. Secure the rear brace (1) to the seat back support with three 5/16-18 x 1-3/4 hex-head bolts (2), six washers (3), and three lock nuts (4). Tighten the hardware to 45 in-lb (5.1 N-m).

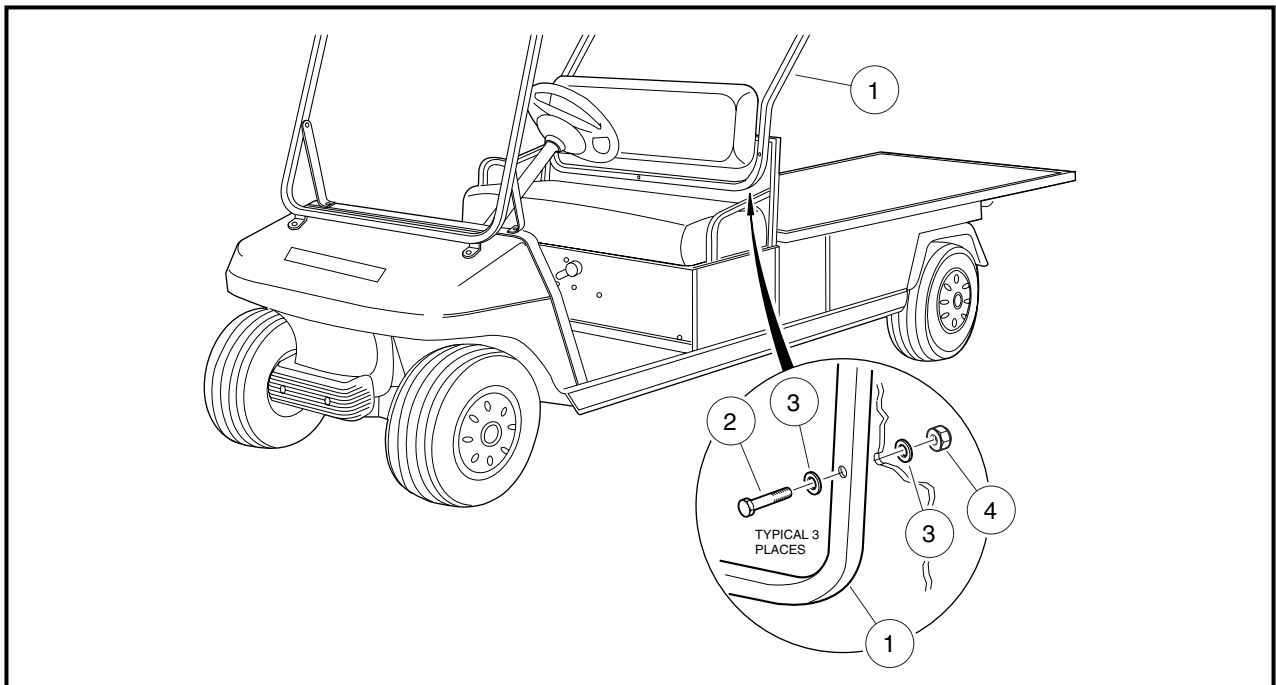

Figure 5 Install Rear Brace

4. DRILL CANOPY MOUNTING HOLES

NOTE: This step is only necessary for a canopy that does not have predrilled mounting holes. If the canopy has predrilled mounting holes, proceed to step 5.

- 4.1. Place the canopy (1) on the windshield frame (2) and rear brace (3).
- 4.2. Position the front edge of the canopy (1) 16 inches (40.6 cm) in front of the forward-most hole in the windshield frame (2) and with the bottom edges of the windshield frame and rear brace flush with the bottom edge of the canopy frame as shown (**Figure 6**)
- 4.3. Ensure the canopy is positioned properly, and use c-clamps to temporarily secure the canopy to the windshield frame and rear supports.
- 4.4. Use the holes in the windshield frame as a guide to drill four (two per side) 9/32-inch (7.1 mm) diameter holes through the canopy side frame.
- 4.5. Use the holes in the rear supports as a guide to drill four (two per side) 9/32-inch (7.1 mm) diameter holes through the canopy side frame.
- 4.6. Proceed to step 5.2.

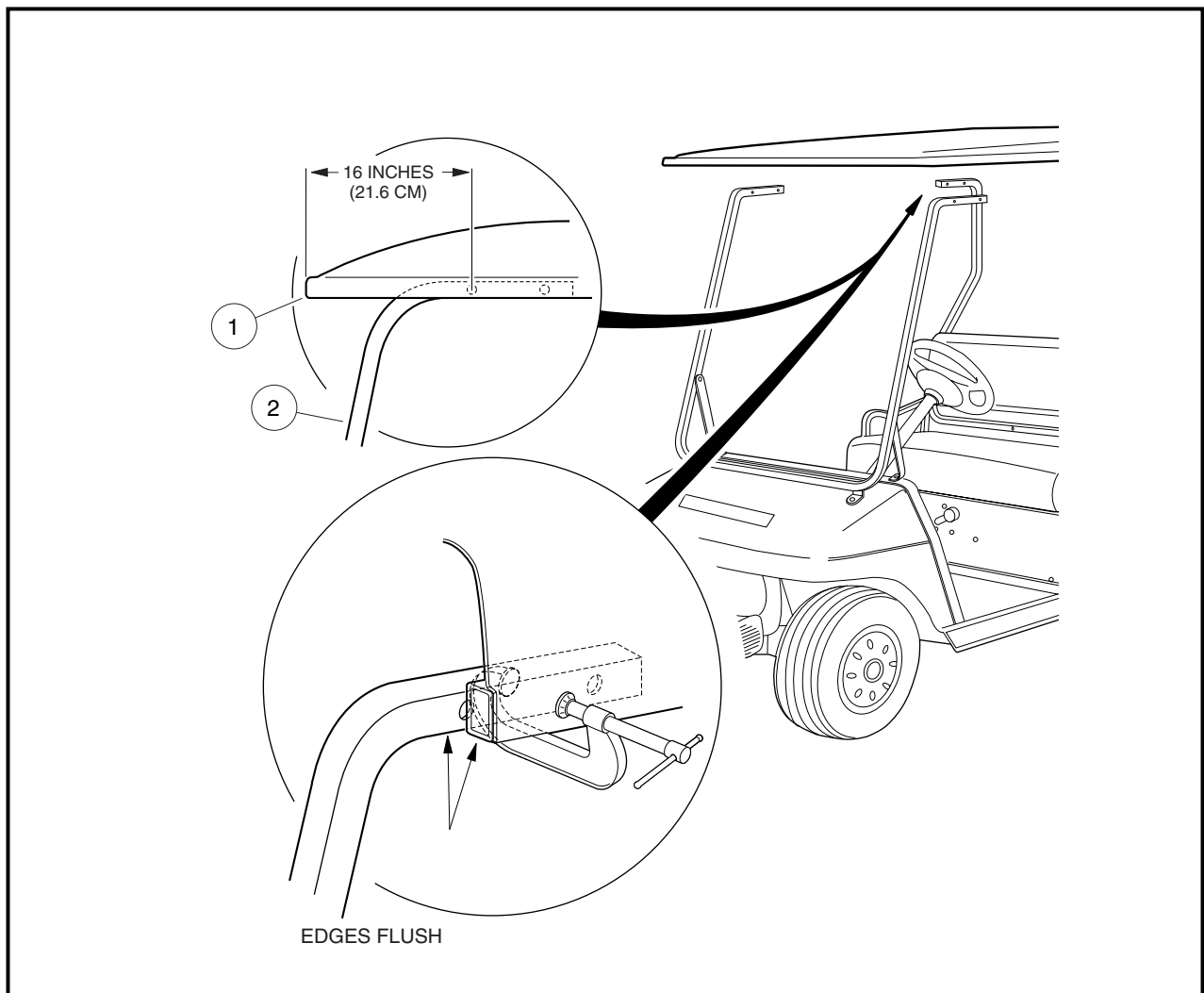

Figure 6 Locate and Drill Holes in Canopy

5. INSTALL CANOPY

- 5.1. Place the canopy (1) on the windshield frame (2) and rear supports (3). Align the holes in the canopy with the holes in the windshield frame and rear supports (**Figure 7**).
- 5.2. Secure the canopy loosely to the windshield frame and rear supports with eight 1/4-20 x 2-3/4 hex-head bolts (4), sixteen washers (5), and eight lock nuts (6) (**Figure 7**).
- 5.3. Tighten the hardware to 45 in-lb (5.1 N-m).
- 5.4. Remove the c-clamps.

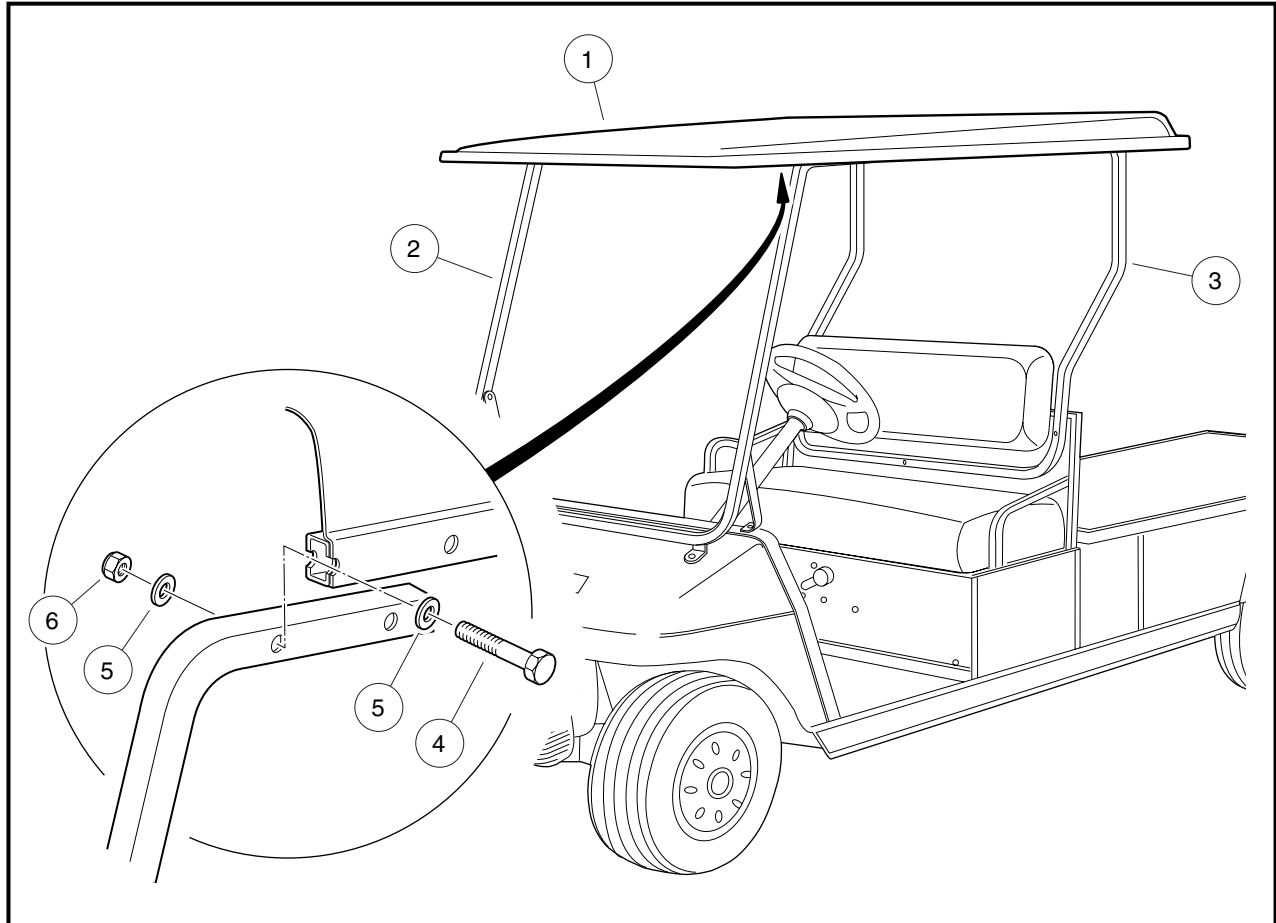

Figure 7 Canopy Installation

6. CONNECT BATTERY CABLES

- 6.1. Connect the battery cables, positive (+) cable first. For gasoline vehicles, tighten hardware to 20 ft-lb (27.1 N-m) (**Figure 1**). For electric vehicles, tighten hardware to 110 in-lb (12.4 N-m) (**Figure 2**). Coat terminals with Battery Terminal Protector Spray (CCI P/N 1014305) to minimize corrosion.

QUESTIONS

Questions or comments regarding these kit instructions should be referred to your local Club Car dealer or distributor. Please know your vehicle model and have these kit instructions available when you call.